

Wing AR

SURFACE

INSTALLATION INSTRUCTIONS

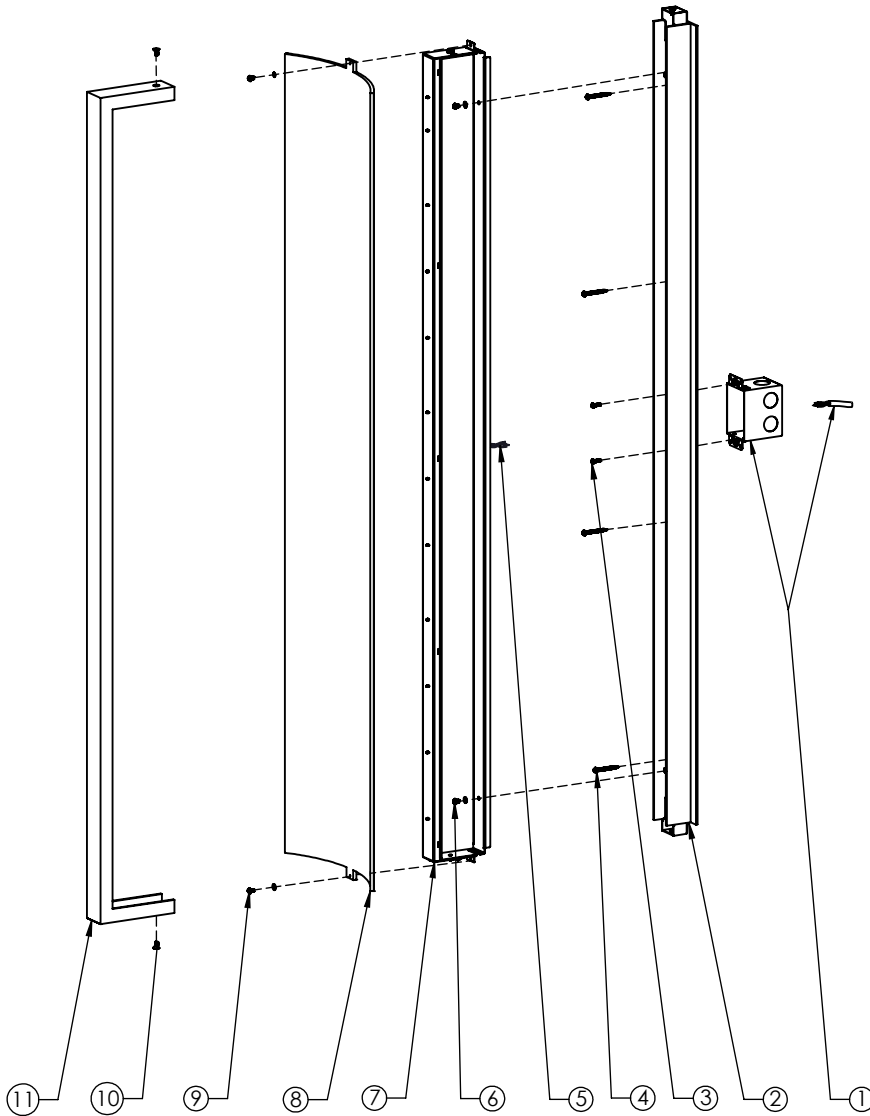
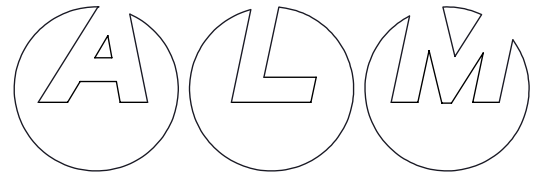

1	2"x 3" junction box and power feed (by others)
2	Back assembly
3	Mounting screws to junction box 6-32 x 3/4" long, round head (by others)
4	Additional mounting hardware (provided)
5	Fixture power wires
6	Light body assembly mounting screws (x2)
7	Light body assembly
8	Reflector
9	Reflector mounting screws (x2)
10	Front assembly mounting screws (x2)
11	Front assembly

INSTRUCTIONS:

1. Unscrew front assembly mounting screws and remove front assembly.
2. Unscrew light body assembly mounting screws and remove light body assembly from the back assembly.
3. Bring the electrical power feed through the hole in back assembly, secure back assembly to the junction box (screws by others) and to the ceiling / wall using mounting hardware provided. If junction box is not available, secure back assembly to the ceiling / wall using additional mounting hardware provided.
4. Splice the fixture power wires and power feed as required and secure light body assembly back into place. Wires for connection are clearly labeled.
5. Secure reflector on to the back assembly using reflector mounting screws provided.
6. Mount front assembly back into place.
7. Energize.

GENERAL NOTE:

- * Turn power off before beginning.
- * Do not connect to an ungrounded supply.
- * Consult a qualified electrician to ensure correct branch circuit conductor.
- * This product must be installed in accordance with the applicable installation code by a person familiar with the construction and operation of the product and the hazards involved.
- * Save these instructions.